

Vue Sud 1:200

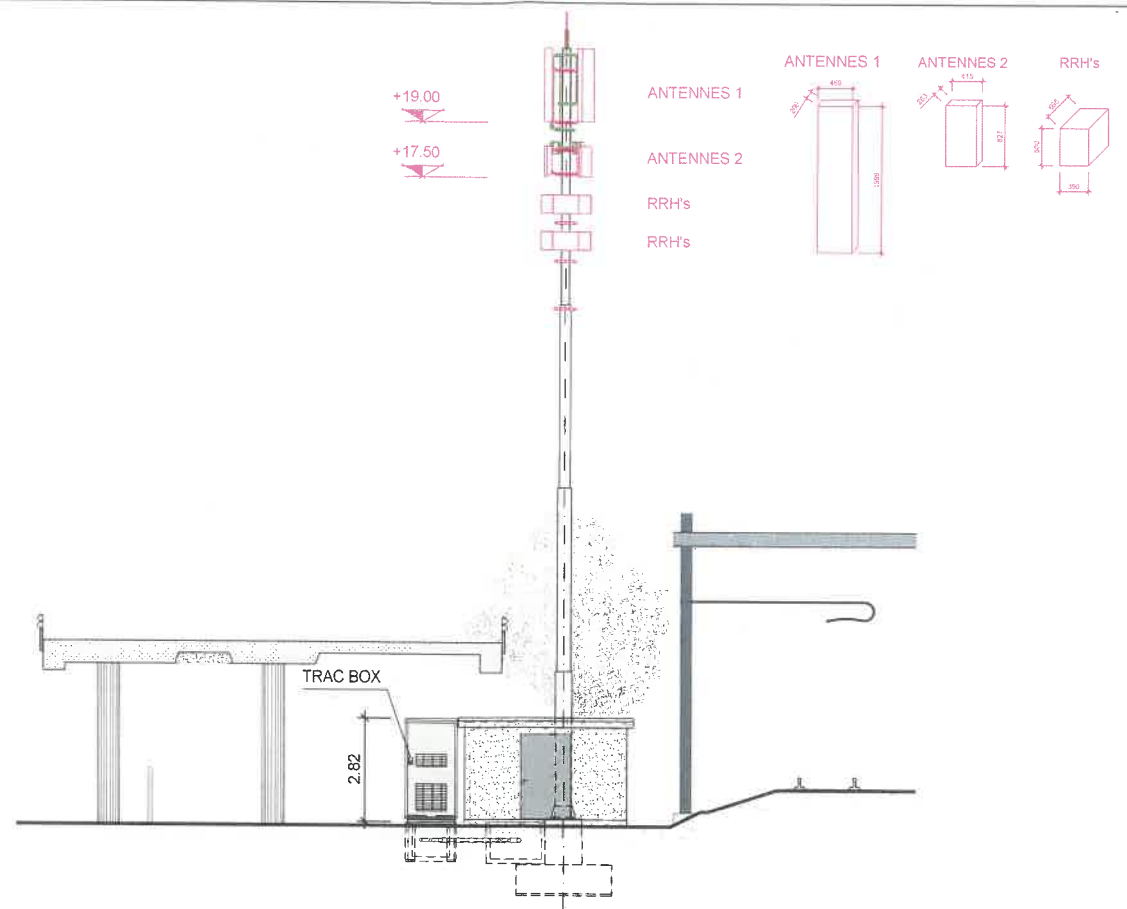

Coupe A-A 1:200

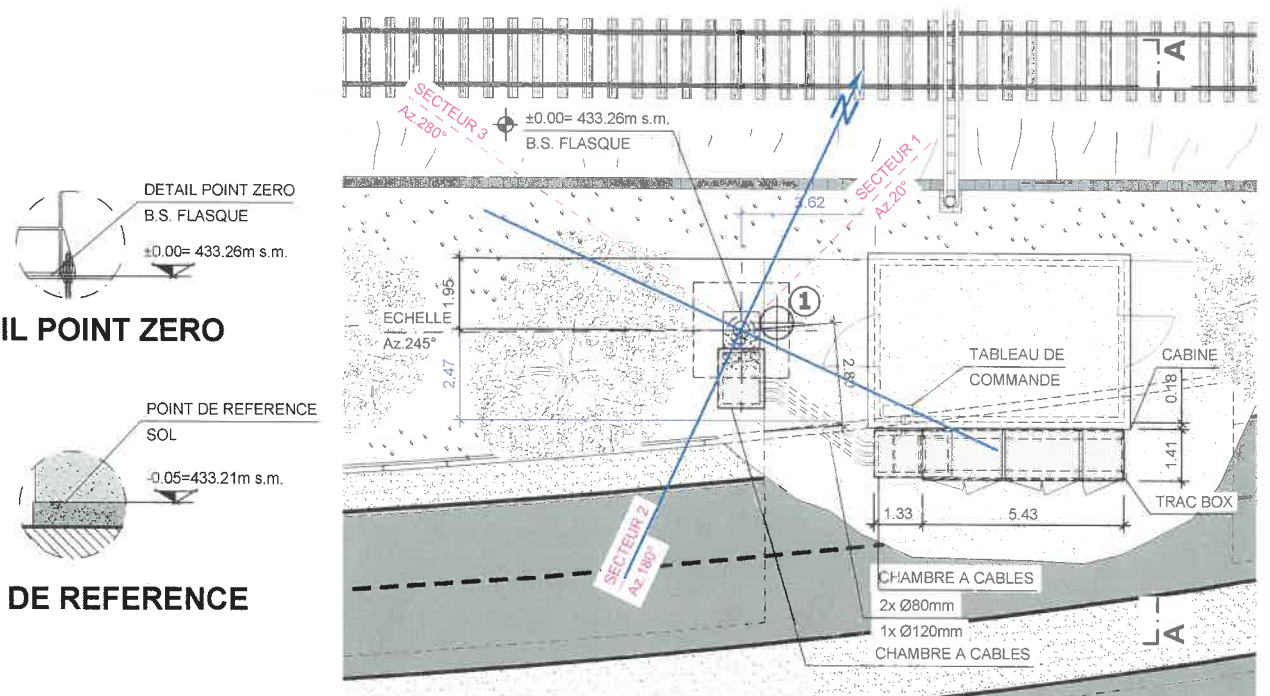

Situation 1:200

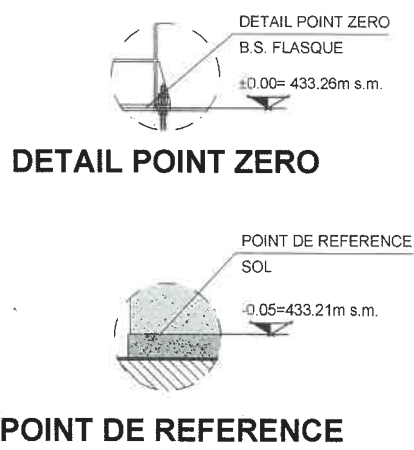

MAITRE DE L'OUVRAGE



SWISSCOM (SUISSE) SA

PROPRIETAIRE DU FONDS

AUTEUR DU PROJET

Hitz et Partner SA
INGENIEURS CONSTRUCTIONS METALLIQUES
Avenue de Savoie 10
1003 Lausanne

PROPRIETAIRE DU SITE



SWISSCOM (SUISSE) SA

LOCAL TECHNIQUE **NECE Rev. 1.48 02.07.2019**

COMMUNE/CT: La Neuveville / BE Parcelle N° 85.01	STATION: Chemin des Rives 2520 La Neuveville	<ul style="list-style-type: none"> EXISTANT NOUVEAU A DEMOLIR
CODE: NECE	TITRE: La Neuveville Centre Mise à l'enquête	
CODE OPERATEUR: 21_NECE	COORDONNEES: 574 299 / 212 662 2574 299 / 1212 662	
NUMERO DU PROJET SWISSCOM: 171101000014	TAILLE DU PLAN: Format A3	SWISSCOM (SUISSE) SA

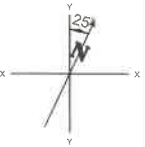
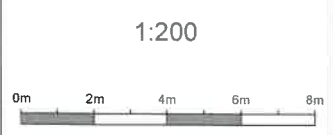

ENGINEERING				MAITRE DE L'OUVRAGE	
VISA	DATE	CONTROLE	DATE	APPROUVE	DATE
M.V.	23.05.2019	IPV	23.05.2019	SCS	23.05.2019
INDEX	DATE	VISA	ADAPTATION		

Designed by Hitz und Partner AG and Solutions Center AG

CANTON DE BERNE
 Commune de La Neuveville
 1:1000
 Demande de construction
 Propriétaires au verso

Les biens-fonds avec
 numéros soulignés ne sont pas
 encore valables juridiquement

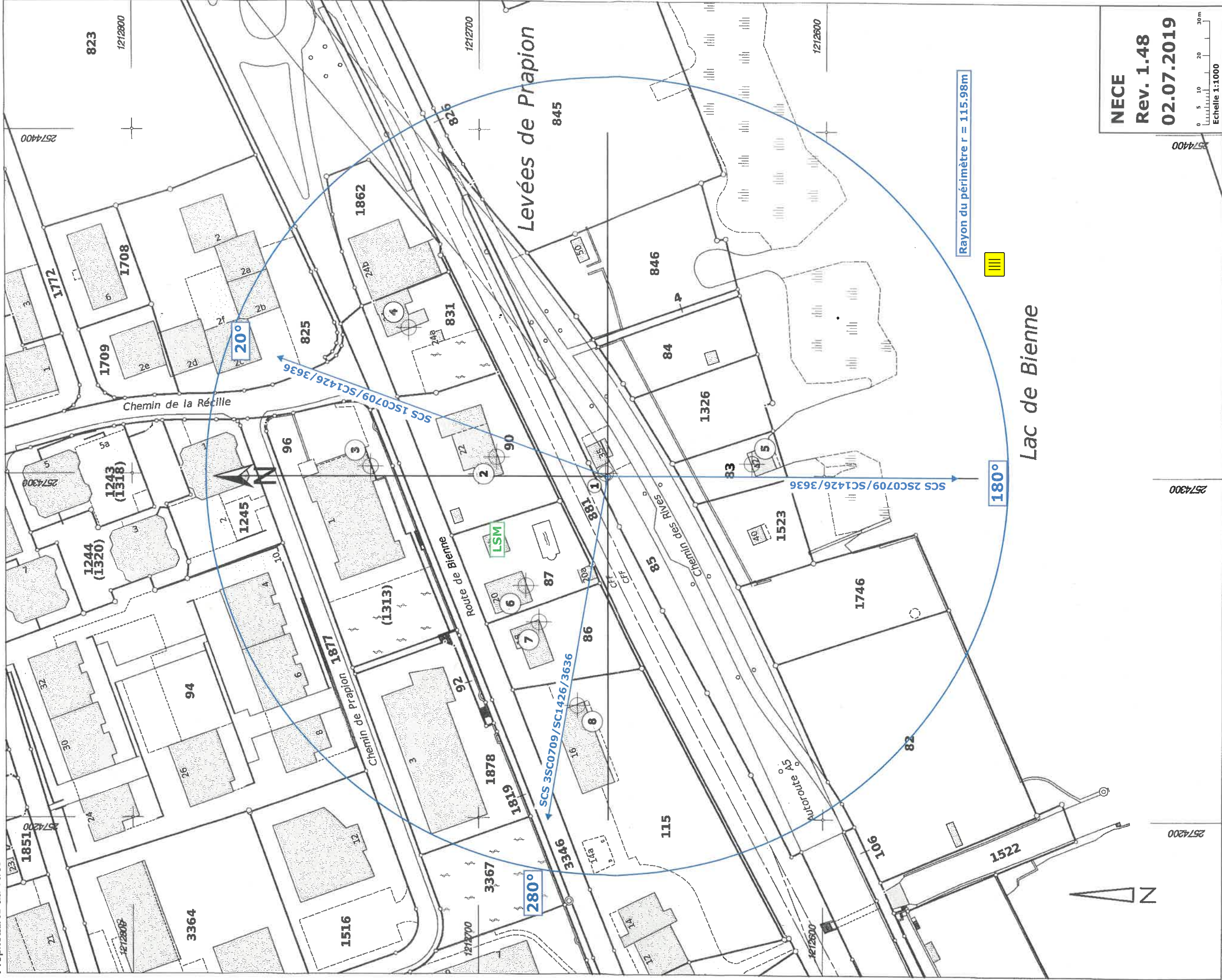

NECE
 Rev. 1.48
 02.07.2019
 Echelle 1:1000

2019.0069

pour l'exactitude de la
 copie du plan cadastral

Lüscher & Aeschlimann SA
 Bureau d'ingénieurs et de géomètres
 Moosgasse 31 3232 Anet

Anet, le 26. 04. 2019
 le géomètre-conserveur :
Charles-Henri Aeschlimann
 Charles-Henri Aeschlimann

Anet, le 26. 04. 2019

le géomètre-conserveur :

Charles-Henri Aeschlimann
 Charles-Henri Aeschlimann

Antenna Diagrams (mobile)

Project : NECE, Revision :1.48

Table des matières

1SC0709	2
2SC0709	3
3SC0709	4
1SC1426	5
2SC1426	6
3SC1426	7
1SC3636	8
2SC3636	9
3SC3636	10

1SC0709

AHP4518R4v06.070809.ADI.msi
FREQUENCY 738 791 921

GAIN

TILT ELECTRICAL 0

created by: , date: 2018.04.09, envelope of antennas: AHP4518R4v06
HORIZONTAL 360

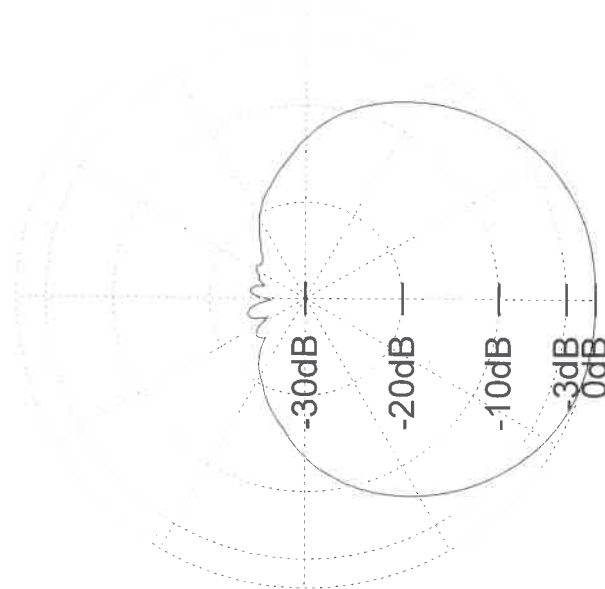

AHP4518R4v06.070809.ADI (horizontal)

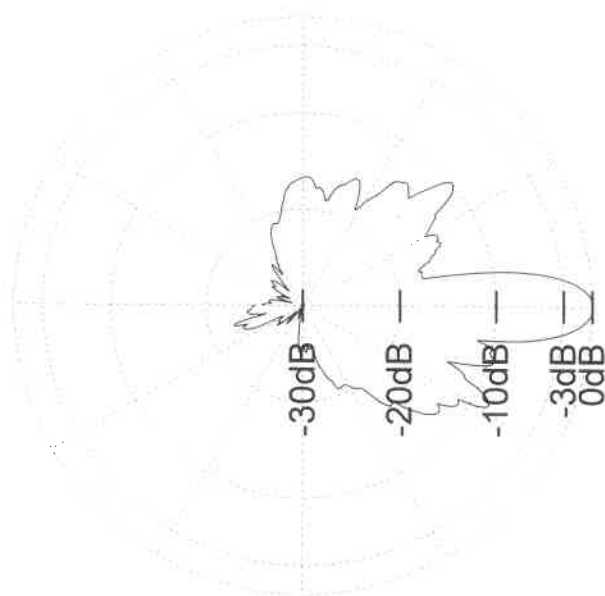

AHP4518R4v06.070809.ADI (vertical)

2SC0709

AHP4518R4v06.070809.ADI.msi

FREQUENCY 738 791 921

GAIN

TILT ELECTRICAL 0

created by: , date: 2018.04.09, envelope of antennas: AHP4518R4v06

HORIZONTAL 360

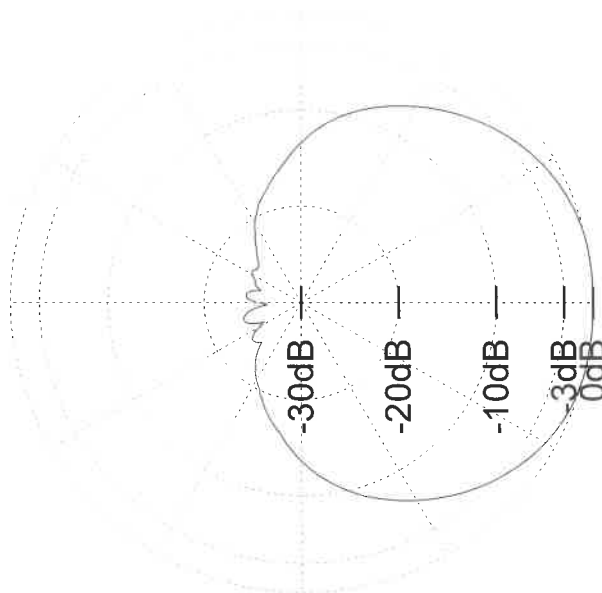

AHP4518R4v06.070809.ADI (horizontal)

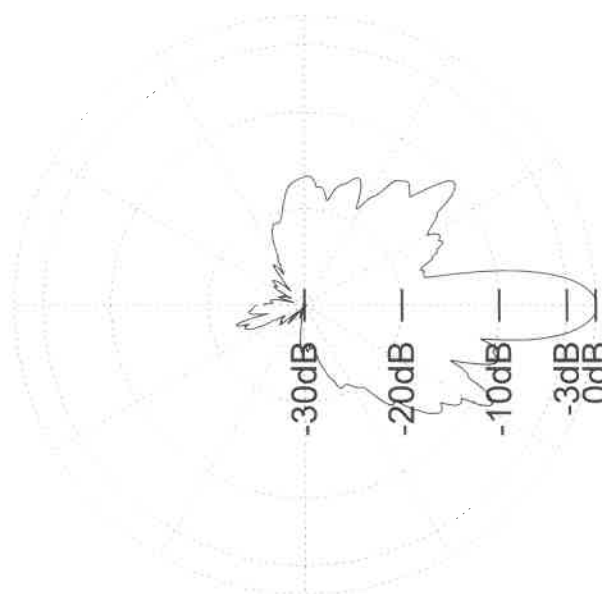

AHP4518R4v06.070809.ADI (vertical)

3SC0709

AHP4518R4v06.070809.ADI.msi

FREQUENCY 738 791 921

GAIN

TILT ELECTRICAL 0

created by: , date: 2018.04.09, envelope of antennas: AHP4518R4v06

HORIZONTAL 360

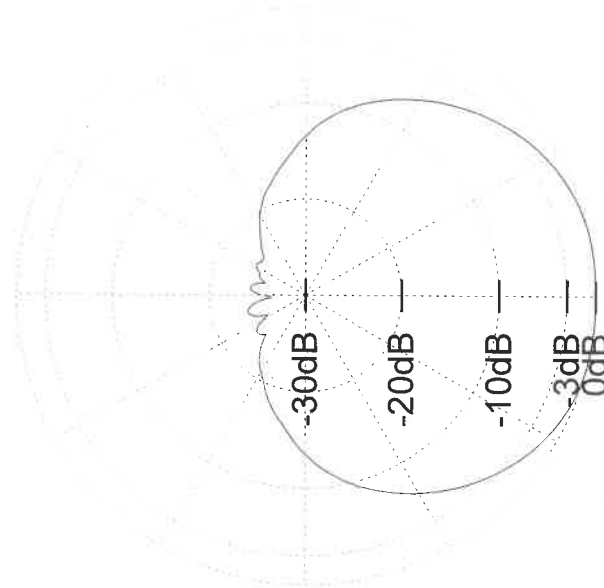

AHP4518R4v06.070809.ADI (horizontal)

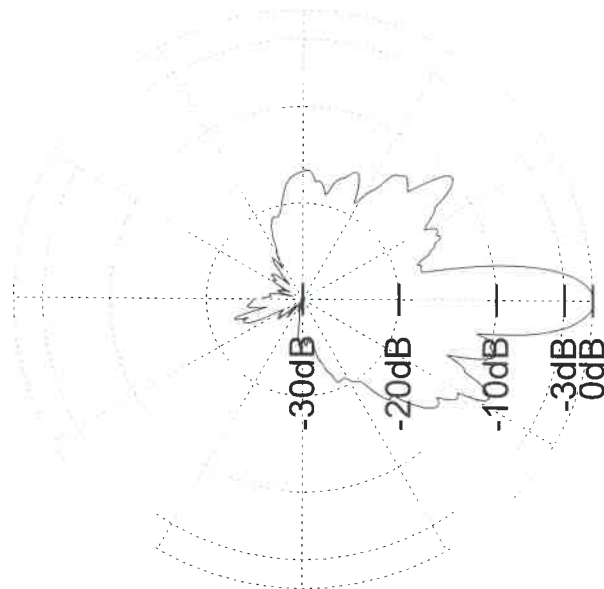

AHP4518R4v06.070809.ADI (vertical)

ISC1426

AHP4518R4v06.14182126.ADI.msi
FREQUENCY 1427 1805 2110 2500
GAIN
TILT ELECTRICAL 0
created by: , date: 2018.04.09, envelope of antennas: AHP4518R4v06
HORIZONTAL 360

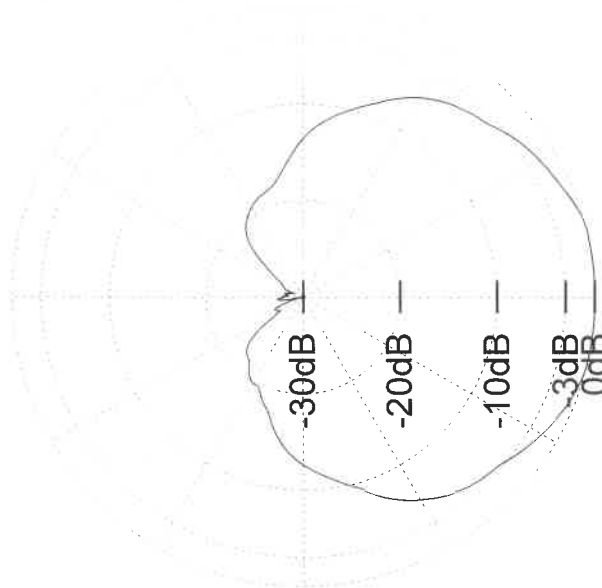

AHP4518R4v06.14182126.ADI (horizontal)

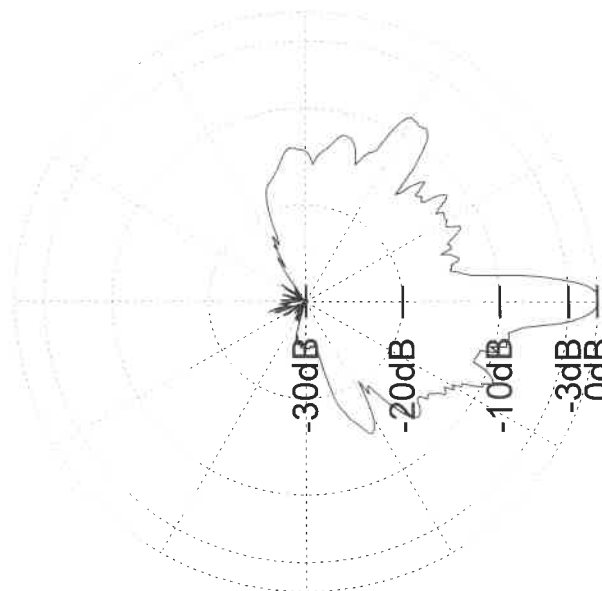

AHP4518R4v06.14182126.ADI (vertical)

2SC1426

AHP4518R4v06.14182126.ADI.msi
FREQUENCY 1427 1805 2110 2500
GAIN
TILT ELECTRICAL 0
created by: , date: 2018.04.09, envelope of antennas: AHP4518R4v06
HORIZONTAL 360

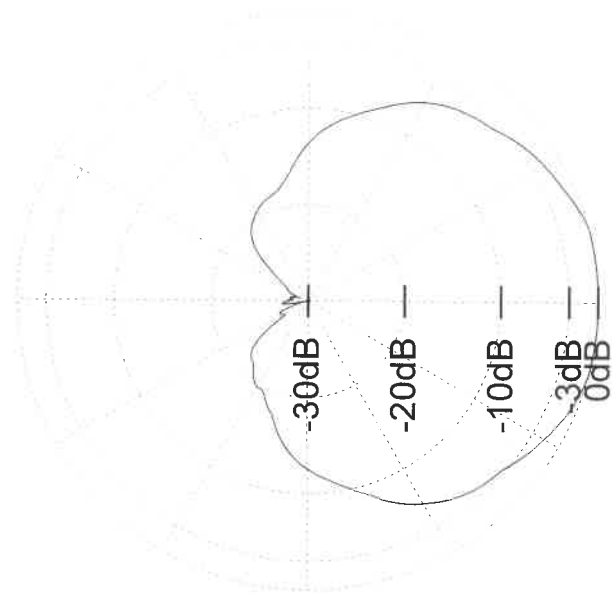

AHP4518R4v06.14182126.ADI (horizontal)

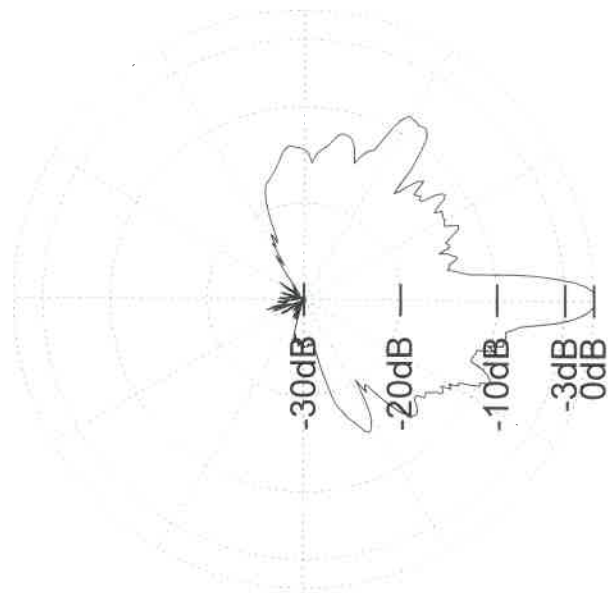

AHP4518R4v06.14182126.ADI (vertical)

3SC1426

AHP4518R4v06.14182126.ADI.msi
FREQUENCY 1427 1805 2110 2500

GAIN

TILT ELECTRICAL 0

created by: , date: 2018.04.09, envelope of antennas: AHP4518R4v06

HORIZONTAL 360

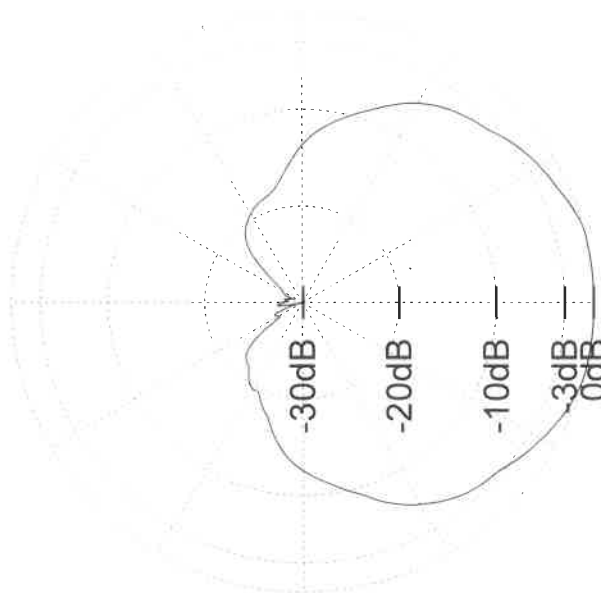

AHP4518R4v06.14182126.ADI (horizontal)

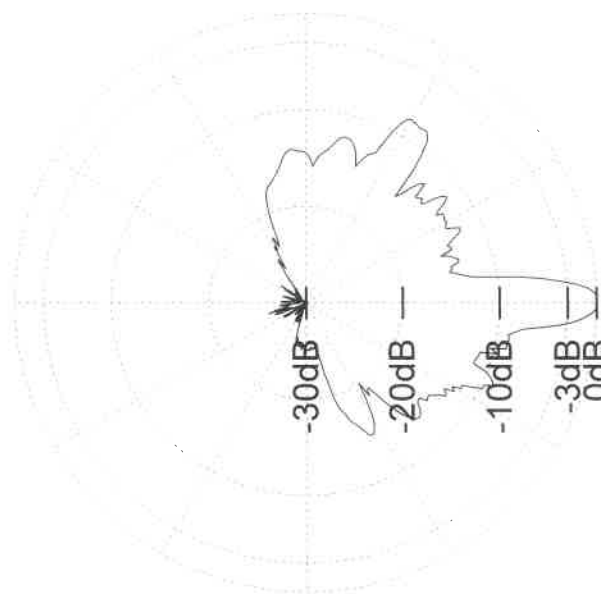

AHP4518R4v06.14182126.ADI (vertical)

1SC3636

AIR6488B43.36.ENV001.msi

FREQUENCY 3600

GAIN

TILT ELECTRICAL 0

created by: , date: 2019.03.28, envelope of antennas: AIR6488

HORIZONTAL 360

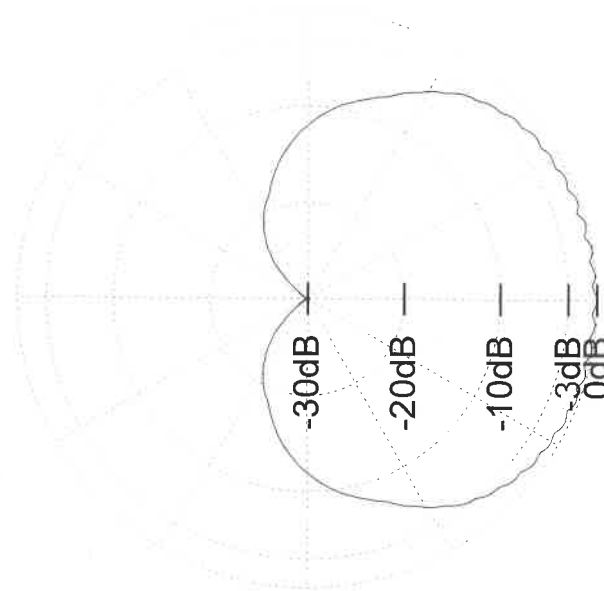

AIR6488B43.36.ENV001 (horizontal)

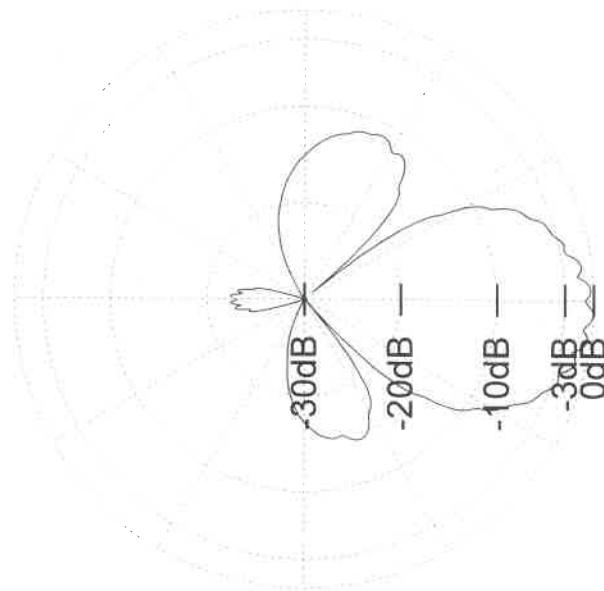

AIR6488B43.36.ENV001 (vertical)

2SC3636

AIR6488B43.36.ENV001.msi

FREQUENCY 3600

GAIN

TILT ELECTRICAL 0

created by: date: 2019.03.28, envelope of antennas: AIR6488

HORIZONTAL 360

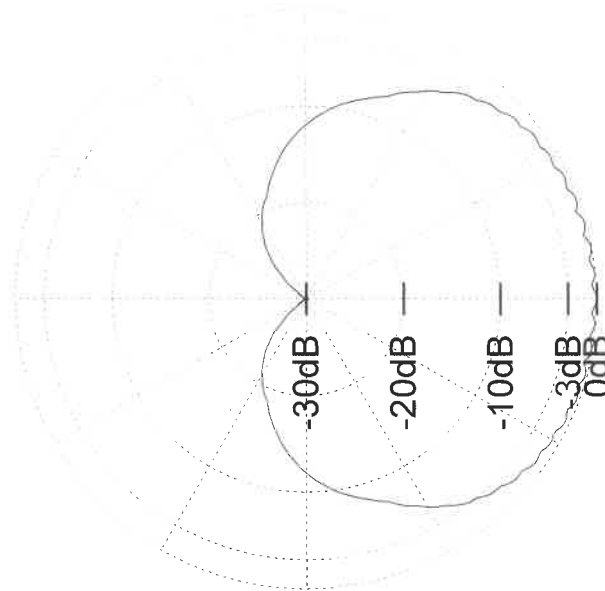

AIR6488B43.36.ENV001 (horizontal)

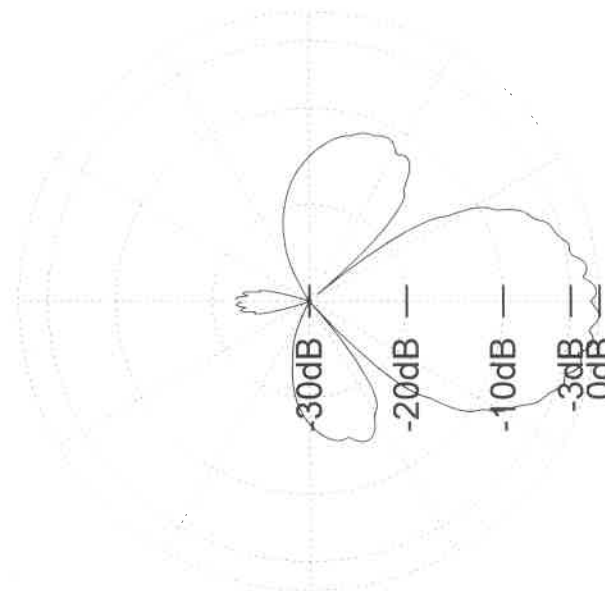

AIR6488B43.36.ENV001 (vertical)

3SC3636

AIR6488B43.36 ENV001.msi

FREQUENCY 3600

GAIN

TILT ELECTRICAL 0

created by: , date: 2019.03.28, envelope of antennas: AIR6488

HORIZONTAL 360

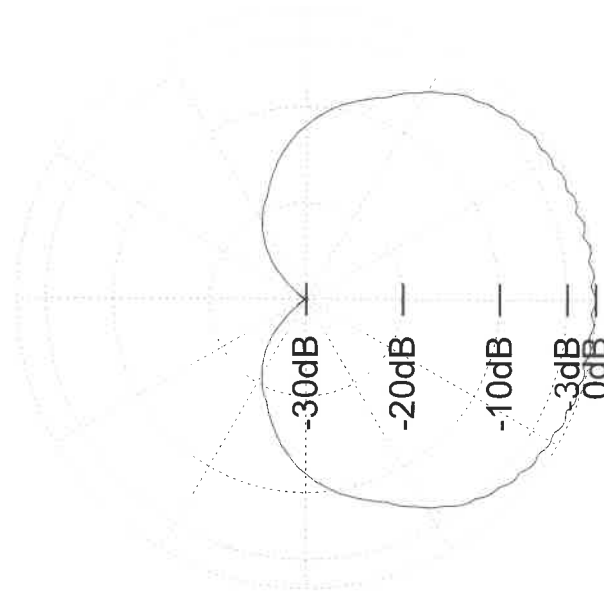

AIR6488B43.36 ENV001 (horizontal)

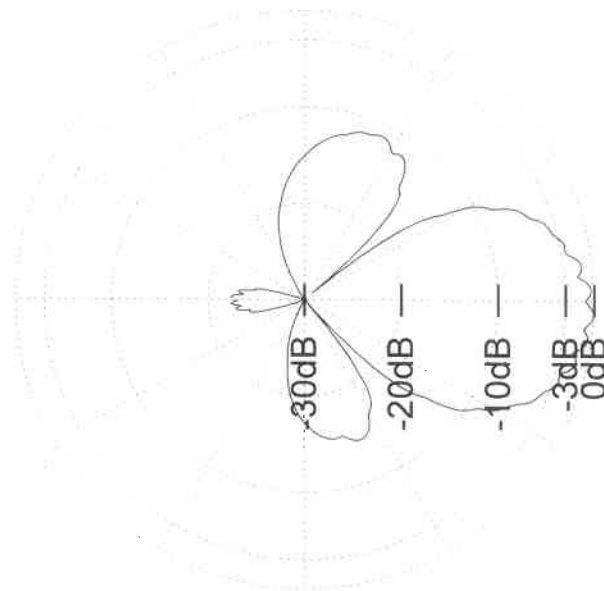

AIR6488B43.36 ENV001 (vertical)